

IP44

- GB The fitting is splash-proof.
- NL Het armatuur is spatwaterdicht.
- F L'armature est étanche aux projections d'eau.
- D Die Armatur ist spritzwasserdicht.
- N Armaturet er beskyttet mot sprut.
- S Armaturen är tät mot stänkvatten.
- DK Armaturet er stænktæt.
- FIN Valaisin on roiskevedenpitävä.
- PL Urządzenie jest bryzgoszczelne.
- RUS Осветительная арматура является брызгозащитной.
- BG Осветителното тяло е устойчиво на намокряне.
- H A szerelvény fröccsenésálló.
- RO Corpul de iluminat este rezistent la stropire.
- SK Zariadenie je chránené proti postriekaniu.
- HR Svjetiljka je zaštićena protiv štrcanja vode.
- CZ Zařízení je chráněno proti postřiku.
- SLO Nosilec je odporen proti curkom.
- I La lampada è protetta contro gli spruzzi d'acqua.
- P A ferragem de conexão é a prova de salpicos.
- E El montaje está protegido contra salpicaduras.
- GR Η εφαρμογή είναι αδιάβροχη στα πιτσιλίσματα.
- TR Tertibat sıçramalara karşı dayanıklıdır.

IP44

1x AA NiMH 1.2V DC 400 mAh

2x LED 0.06W RGB

2x LED 0.06W White

GUARANTEE 2 YEARS



|   |  |                  |
|---|--|------------------|
| smartwares<br>safety & lighting<br>Broekakkerweg 15<br>5126 BD Gilze<br>The Netherlands<br>WWW.RANEX.EU | NL : 0900-2088888 lokaal tarief  | CUSTOMER SERVICE |
|   | BE : 070-233031 lokaal tarief  |                  |
|   | F : 0825 560 650 15ct/min.   |                  |
|   | DE : +49 (0) 1805 010762<br>14ct/Min. dt. Festnetz,<br>Mobil max. 42ct/Min |                  |
|   | UK : +44 (0) 345 230 1231<br>ES : +34 938427589                            |                  |

20150305.5000.391.GA.JB

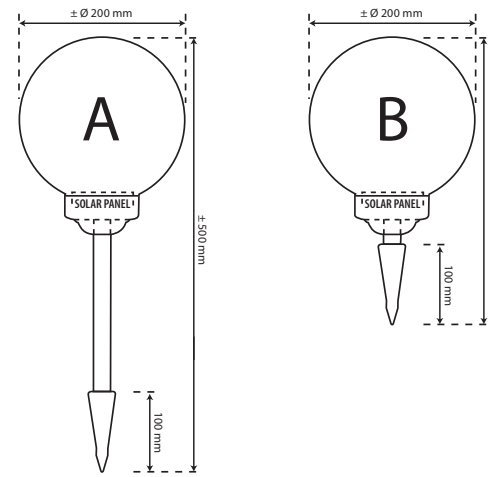
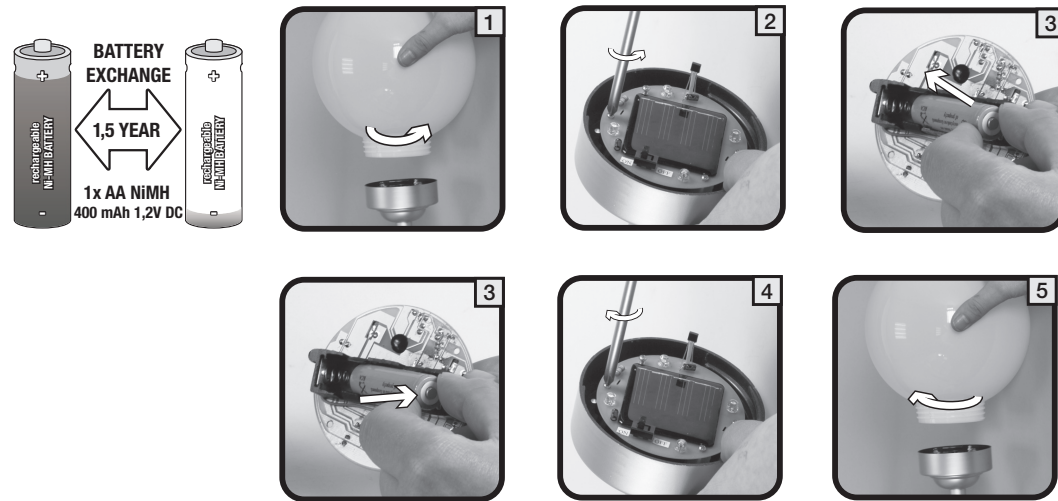
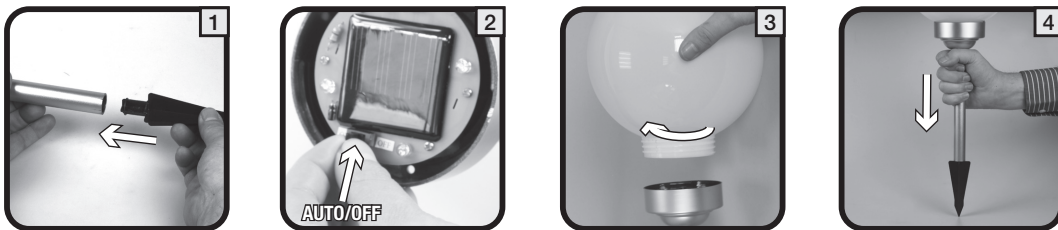

Remote control

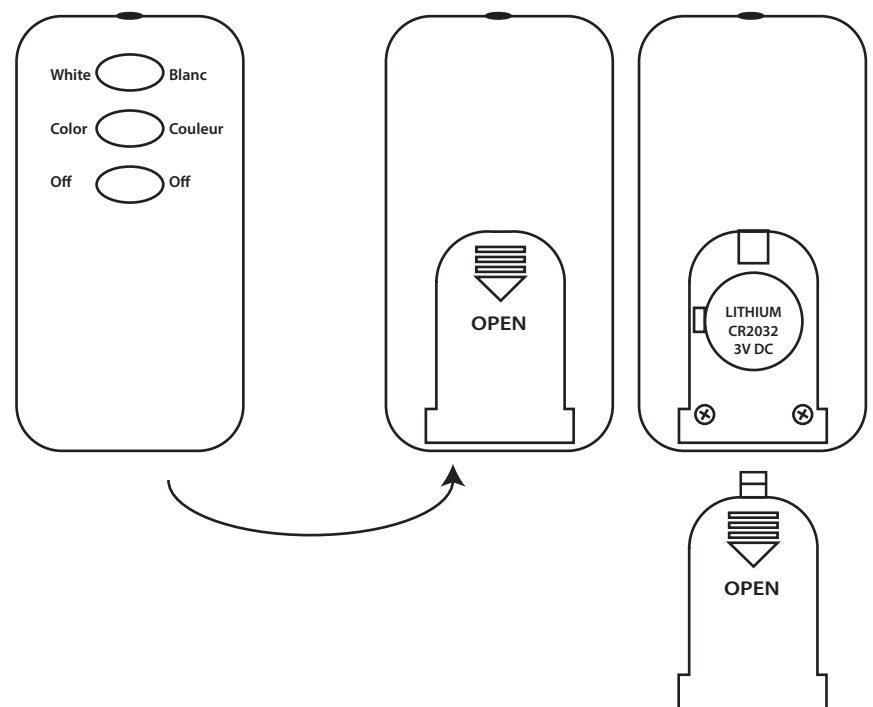

sunshine hours - heures de soleil  
Sonnenlichtstunden - zonuren

lighting time - heures d'éclairage  
Brennstunden - branduren

|    |         |   |         |
|----|---------|---|---------|
| 7  | SUM     | 4 | WIN     |
| 8  | STUNDEN | 5 | STUNDEN |
| 9  | HEURES  | 6 | HEURES  |
| 10 | STUNDEN | 8 | HEURES  |
| 9  | HEURES  | 6 | HEURES  |
| 8  | STUNDEN | 5 | HEURES  |
| 7  | HEURES  | 4 | STUNDEN |