



smartwares®



INDOOR AND
OUTDOOR



MOTION
DETECTION

60

WATT
MAX.



180° max. 3M
110° max. 12M

outdoor light with motion detector

- GB** Outdoor light with 180°
passive infrared detector
- DE** Außenleuchte mit 180°
P.I.R Bewegungsmelder
- PL** Oświetlenie zewnętrzne z pasywnym
dedektorem podczerwieni o kącie 180°

- NL** Buitenverlichting met 180°
P.I.R. bewegingsmelder
- FR** Applique murale extérieure avec
decteur de mouvement angle 180°
- ES** Luz exterior con detector infrarrojo
pasivo y ángulo de acción de 180°

ES68A / 10.021.18

smartwares® ES68A



This luminaire is
compatible with bulbs
of the energy classes:

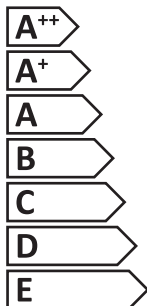

874/2012



smartwares® ES68A



Diese leuchte ist für
Leuchtmittel der
Energieklassen
geeignet:

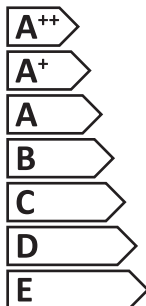

874/2012



smartwares® ES68A



In deze armatuur
passen lampen van
energieklassen:

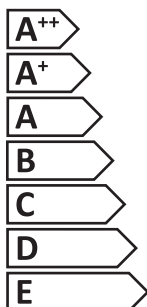

874/2012



smartwares® ES68A



Ce luminaire est
compatible avec
les ampoules des
classes énergétiques:

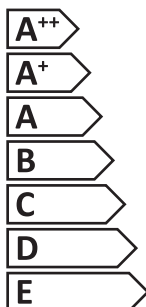

874/2012



IP44



Service smartwares.eu	smartwares® safety & lighting B.V.	NL: 0900-2088888	Lokaal Tarief
	Jules Van der Vlietweg 87	BE: 070-233031 (NL) Lokaal Tarief	
	5015 BH Tilburg	FR: 0825 560 650 15c/min	
	The Netherlands	DE: +49 (0) 1805 010762	
		14c/Min. dt. Festnetz	
		Mobil max. 42c/Min	
		UK: +44 (0) 345 230 1231	
		ES: +34 938272589	
CUSTOMER SERVICE			

10.021.18-20150120.GAL4A

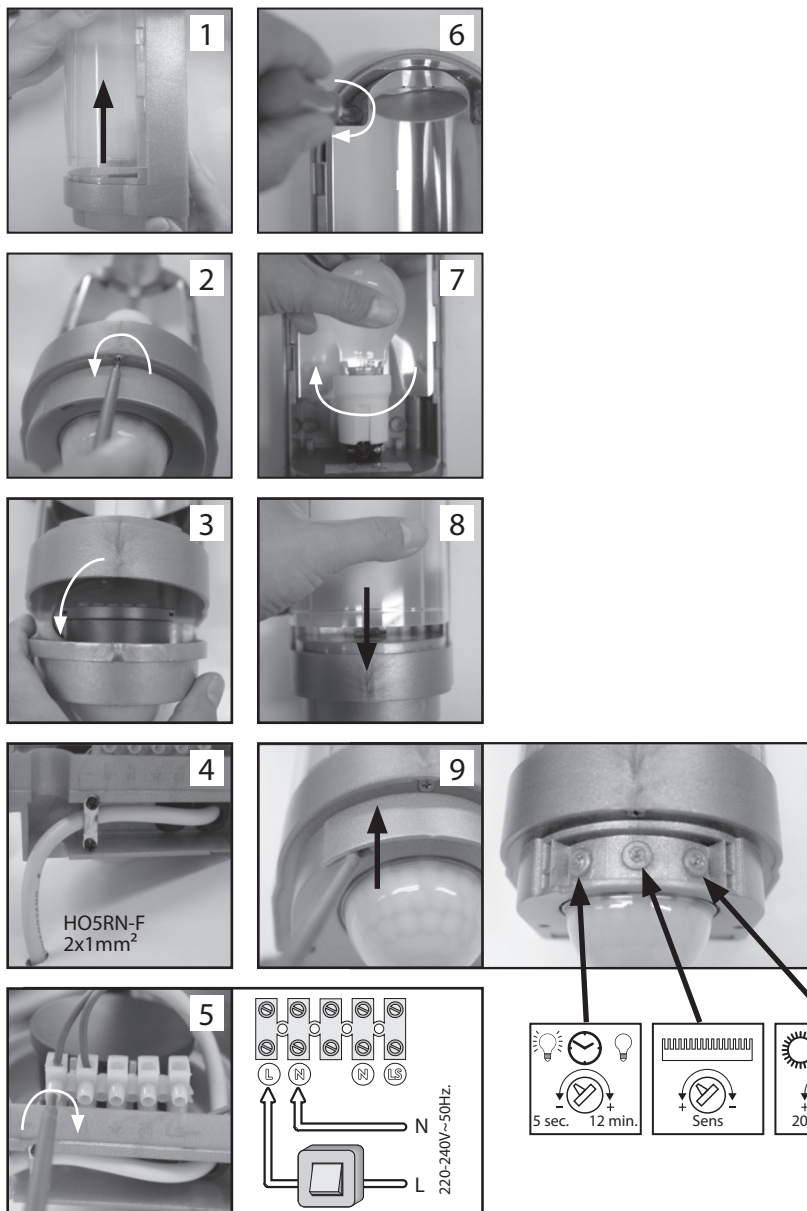

ES68A / 10.021.18

POWER	220-240V~ 50Hz
WATTAGE	13W CFL or 60W incandescent lamp
PROTECTION CLASS	IP44
DIMMABLE	NO