

smartwares® GWI-002-HW

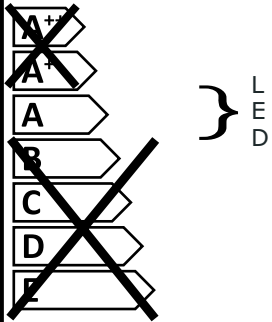

Diese Leuchte enthält eingebaute LED-Lampen.



Die Lampen können in der Leuchte nicht ausgetauscht werden.

874/2012



smartwares® GWI-002-HW



Ce luminaire comporte des lampes à LED intégrées.

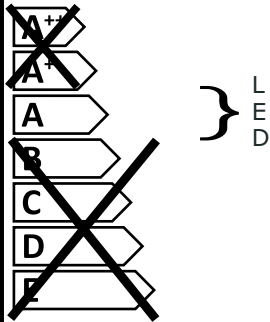

Les lampes de ce luminaire ne peuvent pas être changées.

874/2012



smartwares® GWI-002-HW



This luminaire contains built-in LED lamps.

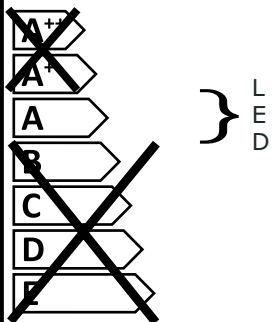

The lamps cannot be changed in the luminaire.

874/2012



smartwares® GWI-002-HW



Deze armatuur bevat ingebouwde LED-Lampen.

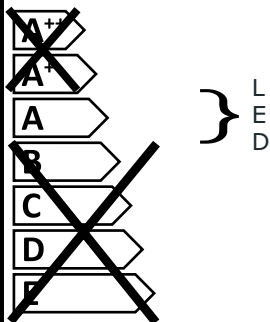

In de armatuur kunnen de lampen niet worden vervangen.

874/2012



IP54



CUSTOMER SERVICE	
NL	: 0900-208888 - Lokaal tarief
BE	: 070-233031 (NL) Lokaal tarief
	: 0800-97570 (FR) Gratuit
FR	: 0825 560 650 - 15ct/min
DE	: +49 (0) 1805 010762
	: 14ct./Min. dt. Festnetz,
	: Mobil max. 42ct./Min
UK	: +44 (0) 345 230 1231
ES	: +34 938427589
smartwares	
safety & lighting bv	
Jules Verneweg 87	
5015 BH Tilburg	
The Netherlands	
WWW.SMARTWARES.EU	



smartwares®

LED  
LIGHT incl.



INDOOR AND  
OUTDOOR

AI

ALUMINIUM

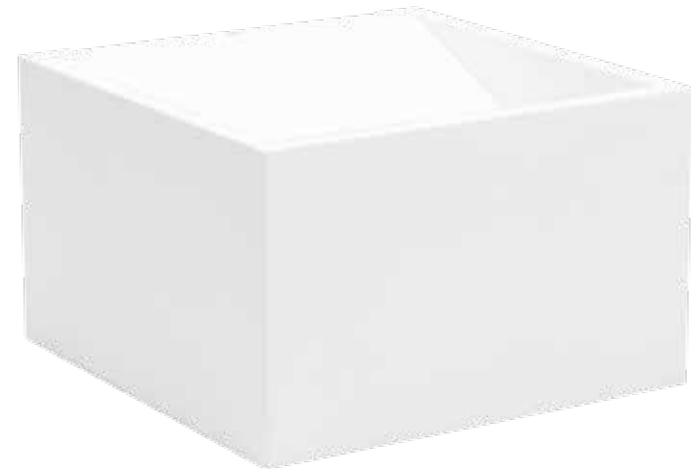

Steffi

aluminium LED outdoor light

EN LED outdoor light  
DE LED Außenleuchte  
PL Oświetlenie zewnętrzne

NL LED buitenverlichting  
FR Applique murale extérieure LED  
ES Luz exterior LED

GWI-002-HW / 10.027.44

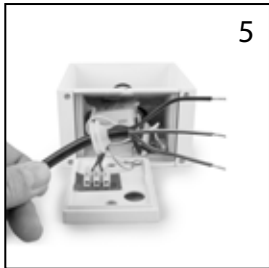
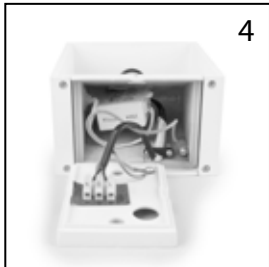
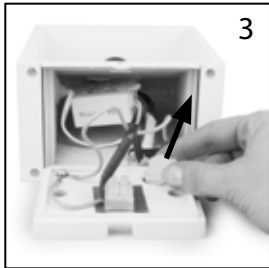
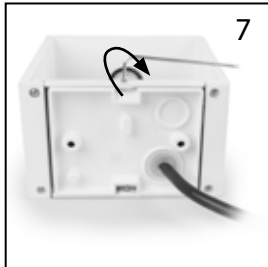
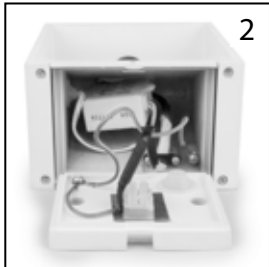
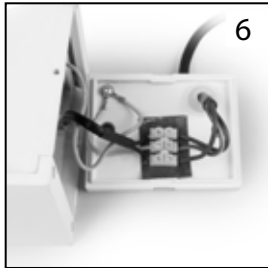
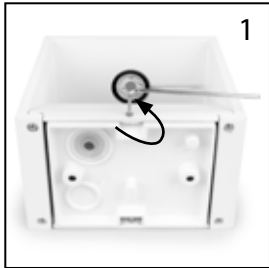

GWI-002-HW (10.027.44)	
POWER	220-240V~ 50/60Hz
LED	Yes, integrated
WATTAGE	9W
LUMINOUS FLUX	550lm
COLOUR TEMPERATURE	±3000 K
CRI	>65
SWITCHING CYCLES	15000
PROTECTION CLASS	IP54
ENERGY CLASS	A
LIFETIME	25.000h
DIMMABLE	NO
ISOLATION CLASS	I
GUARANTEE	2 years

