

smartwares® GWL-176-HG

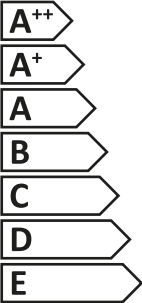

This luminaire is compatible with bulbs of the energy classes:



The luminaire is sold with bulbs of the energy class:



874/2012



smartwares® GWL-176-HG



Diese Leuchte ist für Leuchtmittel der Energieklassen geeignet:

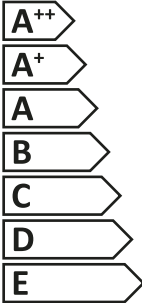

Die Leuchte wird verkauft mit Leuchtmitteln der Energieklasse:



874/2012



smartwares® GWL-176-HG



Ce luminaire est compatible avec les ampoules des classes énergétiques:

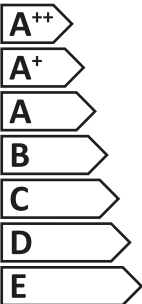

Le Luminaire est vendu avec des ampoules de la classe énergétique:



874/2012



smartwares® GWL-176-HG



This luminaire is compatible with bulbs of the energy classes:

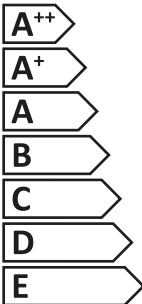

De armatuur wordt verkocht met lampen van energieklasse:



874/2012



220-240V~50Hz
2 x 3W

IP44



CE

CUSTOMER SERVICE

NL: 088 5940501	Lokaal tarief
BE: 078 481 094(NL)	Lokaal tarief
BE: 078 481 140(FR)	Tarif local
FR: 0935 560 650	18ct/min
DE: +49 (0) 1805 010763	14ct/Min. at Escuz
	Mobil: 40ct/Min
	UK: +44 (0) 345 330 1231
	ES: +34 93627389
smartwares® Europe	
Jules Verneweg 87	
5015 BH Tilburg	
The Netherlands	
service.smartwares.eu	



smartwares®



BULBS INCLUDED



STAINLESS STEEL



INDOOR AND OUTDOOR

up and down wall light

NL Up and down wandlamp DE Wandleuchte FR de haut en bas murale ES Luz de pared exterior
IT Applique da esterno PT Aplique Luz Exterior SV upp och ner vägglampor TR Dışmekan duvar lambası
PL w górę iw dół światła na ścianie

GWL-176-HG - 1004807

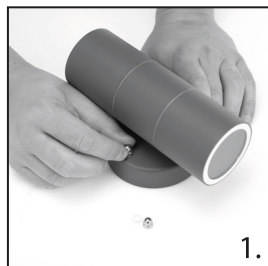

1.

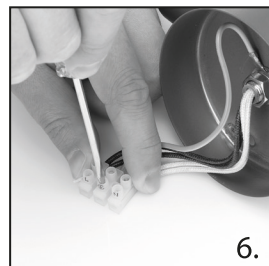

6.



11.

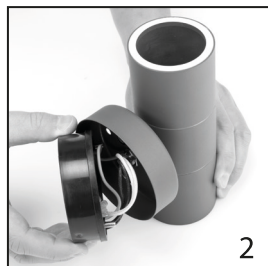

2.

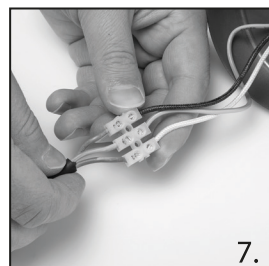

7.



12.

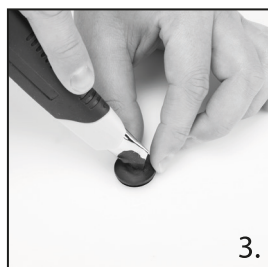

3.

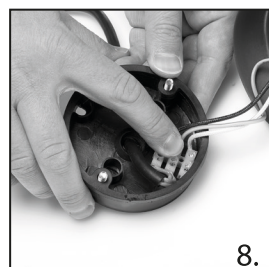

8.

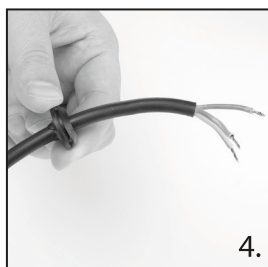

4.



9.

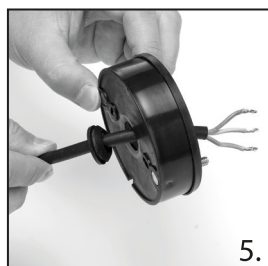

5.



10.

INDOOR AND
OUTDOOR220-240V ~
50Hz

IP44

2x GU10
FITTING

BULBS INCLUDED

2x
3

WATT

2x 230
LUMEN3000K
WARM LIGHT25.000
HOURSNOT
DIMMABLEON / OFF
≥15.000xRa
>80

IP44

**(GB)** The fixture is splash-proof.**(NL)** Het armatuur is spatwaterdicht.**(F)** L'armature est étanche aux projections d'eau.**(D)** Die Armatur ist spritzwasserdicht.**(N)** Armaturet er beskyttet mot sprut.**(S)** Armaturen är tät mot stänkvatten.**(DK)** Armaturet er stænkæt.**(FIN)** Valaisin on roiskevedenpitävä.**(PL)** Urządzenie jest bryzgoszczelne.**(RUS)** Осветительная арматура является брызгозащищенной.**(BG)** Осветителното тяло е устойчиво на намокряне.**(H)** A szerelvény fröccsenésálló.**(RO)** Corpul de iluminat este rezistent la stropire.**(SK)** Zariadenie je chránené proti postriekaniu.**(HR)** Svjetiljka je zaštićena protiv štrcanja vode.**(CZ)** Zařízení je chráněno proti postřiku.**(SLO)** Nosilec je odporen proti curkom.**(I)** La lampada è protetta contro gli spruzzi d'acqua.**(P)** A ferragem de conexão é a prova de salpicos.**(E)** El montaje está protegido contra salpicaduras.**(GR)** Η εφαρμογή είναι αδιάβροχη στα πισιλιόματα.**(TR)** Tertibat sýgramalara karşý dayanýklýdır.**(GB)** Protection class 1: the fitting must be earthed.**(NL)** Beschermklasse 1, het armatuur moet geaard worden.**(F)** Classe de sécurité 1, l'armature doit être mise à la terre.**(D)** Schutzklasse 1, die Armatur muss geerdet werden.**(N)** Beskyttelsesklasse 1: armaturet må jordes.**(S)** Skyddsklass 1, armaturen måste jordas.**(DK)** Beskyttelsesklasse 1, armaturet skal have jordforbindelse.**(FIN)** Suojausluokka 1, valaisin pitää maadoittaa.**(PL)** Klasa zabezpieczenia 1: urządzenie musi być uziemione.**(RUS)** Класс защиты 1: арматура должна быть заземлена.**(BG)** Защита от клас 1: осветителното тяло трябва да е заземено.**(H)** 1. védelmi osztály: a szerelvény földelhető.**(RO)** Clasă 1 de protecție: corpul de iluminat trebuie împământat.**(SK)** Trieda ochrany 1: zariadenie musí byť uzemnené.**(HR)** Klasa zaštite 1: svjetiljka mora biti uzemljena.**(CZ)** Třída ochrany 1: zařízení musí být uzemněno.**(SLO)** Zaščitni razred 1: nosilec senzorja je potrebno ozemljiti.**(I)** Classe di protezione 1, la lampada deve avere la messa a terra.**(P)** Classe 1 de protecção: a ferragem de conexão deve ser ligada à terra.**(E)** Protección de Clase 1: el montaje debe estar conectado a tierra.**(GR)** Προστατευτικό γυαλί 1: η εφαρμογή πρέπει να γειωθεί.**(TR)** Emniyet türü 1: Tertibat topraklanmalıdır.