

Fiësta 5000.370 / 10.010.85

ranex®

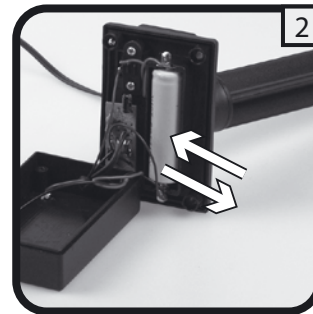
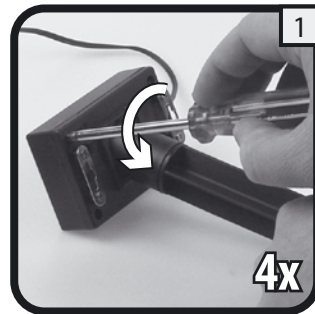
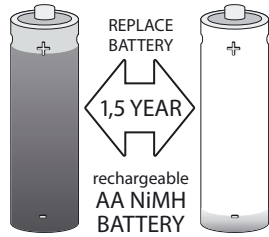
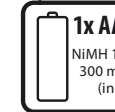
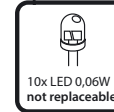
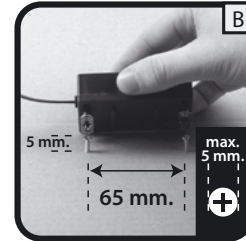
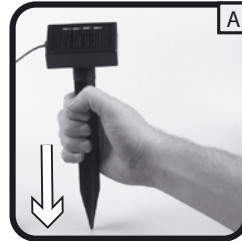

IP44

- GB** The fitting is splash-proof.
- NL** Het armatuur is spatwaterdicht.
- F** L'armature est étanche aux projections d'eau.
- D** Die Armatur ist spritzwasserdicht.
- S** Armaturen är tät mot stänkvattnen.
- DK** Armaturet er stænkttæt.
- FIN** Valaisin on roiskevedenpitävä.
- PL** Urządzenie jest bryzgoszczelne.
- RUS** Осветительная арматура является брызгозащитной.
- BG** Осветителното тяло е устойчиво на намокряне.
- H** A szerelvény fröccsenésálló.
- RO** Corpul de iluminat este rezistent la stropire.
- SK** Zariadenie je chránené proti postriekaniu.
- HR** Svjetiljka je zaštićena protiv štrcanja vode.
- CZ** Zařízení je chráněno proti postřiku.
- SLD** Nosilec je odporen proti curkom.
- I** La lampada è protetta contro gli spruzzi d'acqua.
- P** A ferragem de conexão é a prova de salpicos.
- E** El montaje está protegido contra salpicaduras.
- GR** Η εφαρμογή είναι αδιάβροχη στα πισσιλιόματα.
- TR** Tertibat sýrcamalara karþý dayanýklýdyr.

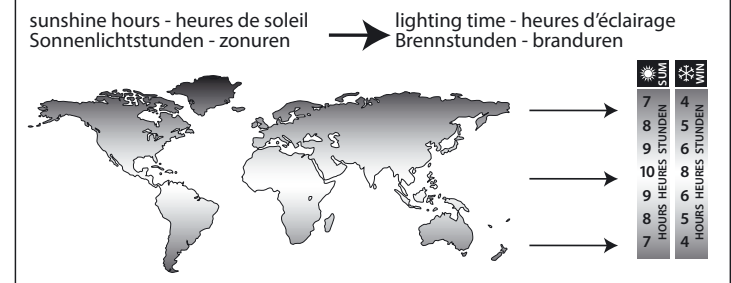
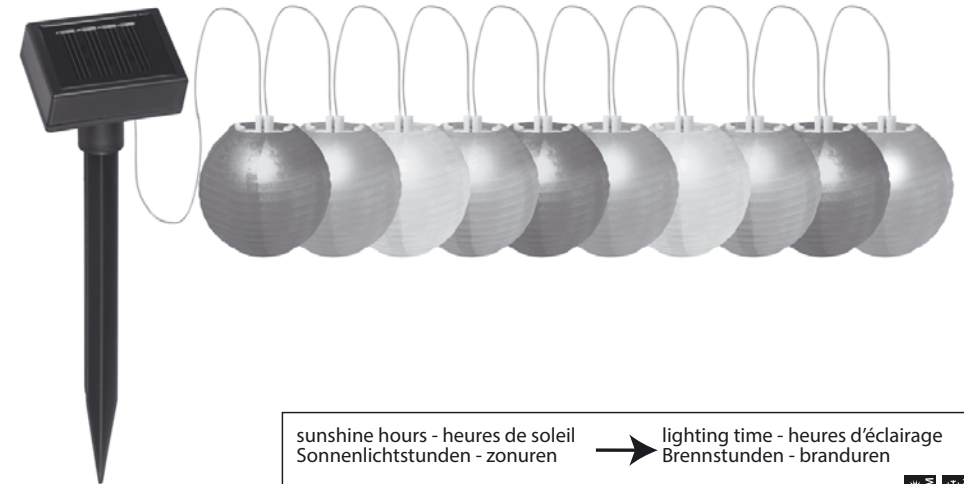

smartwares Europe Jules Verneweg 87 5015 BH Tilburg The Netherlands service.smartwares.eu	NL : 088 5940501	Lokaal tarief
	BE : 078 481094(NL)	Lokaal tarief
	BE : 078 481540(FR)	Tarif local
	FR : 0825 560 650	18ct/min
	DE : +49 (0) 1805 010762	14Ct./Min. dt. Festnetz, Mobil max. 42Ct./Min
UK : +44 (0) 345 230 1231		
ES : +34 938427589		

CUSTOMER SERVICE